

# Twolok conique CL

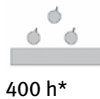

English	Français	Deutsch	Italiano	Español
Washer: Steel XC60 to XC68	Rondelle: Acier XC60 à XC68	Scheibe: Stahl XC60 bis XC68	Rondella: Acciaio XC60 a XC68	Arandela: Acero XC60 a XC68
Hardness: 420 to 510 HV	Dureté: 420 à 510 HV	Härte: 420 bis 510 HV	Durezza: 420 a 510 HV	Dureza: 420 a 510 HV
Nut: Low carbon steel Class 8	Écrou: Acier bas carbone Classe 8	Mutter: Stahl Klasse 8	Dado: Acciaio Classe 8	Tuerca: Acero clase 8
Zinc plated	Zingué	Verzinkt	Zincato	Zincado
Clear passivated	Passivé clair	Transparent chromatiert	Bianco	Pasivado claro
Friction coefficient: 0.12 - 0.18	Coefficient de frottement: 0.12 - 0.18	Reibungskoeffizient: 0.12 - 0.18	Coefficiente d'attrito: 0.12 - 0.18	Coefficiente de fricción: 0.12 - 0.18



≡ PSA C21 3350, RSA 07-33-030, NF E25-415

\*: to red rust / à la rouille rouge / bis Rotrost / alla ruggine rossa / al óxido rojo

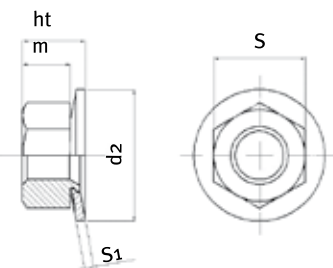

Nut / Écrou / Mutter / Dado / Tuerca Ø	S	Ø d2 h14	S <sub>1</sub>	ht max.	m min.	Part No/ref	Series**
M5 x 0.8	8.0	12.35 0/-0.70	0.9 ±0.03	6.10	4.40	460560	A
		14.20 0/-0.43	1.0 ±0.04	6.40		460502	
		15.00 0/-0.43	1.4 ±0.04	6.70		460504	D
		15.35 0/-0.70	1.0 ±0.04	6.30		460505	B
M6 x 1.0	10.0	12.25 0/-0.52	1.2 ±0.04	6.90	4.90	460602	
		14.20 0/-0.43	1.1 ±0.04	7.00		460607	A
		14.20 0/-0.43	1.4 ±0.04	7.20		460609	C
		18.25 0/-0.52	1.2 ±0.04	7.10		460608	B
		18.25 0/-0.52	1.7 ±0.05	7.50		460604	D
M7 x 1.0	11.0	16.25 0/-0.52	1.4 ±0.04	7.70	5.35	460701	
M8 x 1.25	13.0	18.25 0/-0.52	1.4 ±0.04	8.80	6.44	460803	A
		18.25 0/-0.52	2.0 ±0.05	9.45		460806	
		20.25 0/-0.52	2.2 ±0.05	9.60		460804	
		22.25 0/-0.52	2.2 ±0.05	9.70		460807	D
		22.45 0/-0.90	1.5 ±0.05	9.00		460809	B
		29.00 0/-0.52	2.0 ±0.05	9.80		460831	
		33.00 0/-0.70	2.5 ±0.06	10.30		460833	
M10 x 1.5	16.0	22.25 0/-0.52	1.6 ±0.06	10.70	8.04	461058	A
		22.25 0/-0.52	2.4 ±0.05	11.50		461055	C
		27.25 0/-0.52	2.0 ±0.05	11.20		461057	B

all dimensions in mm / en millimètres / alle Maße in mm / in millimetri / en milímetros

Quality level / Niveau qualité / Qualitätsniveau / Livello di qualità / Nivel de calidad: 150 ppm

Optional heat treatment : Class 10

Traitement thermique optionnel: Classe 10

Optionale Wärmebehandlung: Klasse 10

Trattamento termico opzionale: Classe 10

Tratamiento térmico opcional: Clase 10

\*\*Norme PSA

A = 4N series

B = 4L

C = 8N

D = 8L/RSA/NF



# Twolok conique CL

## Finishes / finition / Oberflächen / superficie / superficie

Type	Description / description / Beschreibung / descrizione / descripción	<del>Cr6</del>	 1)	Code <sup>2)</sup>
Standard	Zinc 8 µm mini clear passivation, friction coefficient 0.12 - 0.18 / Zinc alcalin 8µm mini incolore, coefficient de friction 0.12 - 0.18 / Zink alkalisch 8µm min. transparent, Reibungskoeffizient 0.12 - 0.18 / Zinco alcalino 8µm min. incolore, coefficiente d'attrito 0.12 - 0.18 / Zincado y pasivado claro min. 8 µm, coeficiente de fricción 0.12 - 0.18	✓	400 h	78
Optional	Zinc-nickel 12 - 15 % 8 µm clear, friction coefficient 0.12 - 0.18 / Zinc-nickel 12 - 15 % 8µm incolore, coefficient de friction 0.12 - 0.18 / Zink-Nickel 12 -15 % 8µm min. transparent, Reibungskoeffizient 0.12 - 0.18 / Zinco Nichel 12 - 15 % 8µm incolore, coefficiente d'attrito 0.12 - 0.18 / Zincado y niquelado claro 12 - 15 % min. 8 µm, coeficiente de fricción 0.12 - 0.18	✓	720 h	07
Optional	Zinc-nickel 12 - 15 % 8 µm black, friction coefficient 0.12 - 0.18 / Zinc-nickel 12 - 15 % 8µm noir, coefficient de friction 0.12 - 0.18 / Zink-Nickel 12 -15 % 8µm min. schwarz, Reibungskoeffizient 0.12 - 0.18 / Zinco Nichel 12 - 15 % 8µm nero, coefficiente d'attrito 0.12 - 0.18 / Zincado y niquelado negro 12 - 15 % min. 8 µm, coeficiente de fricción 0.12 - 0.18	✓	720 h	04
Optional	Dacromet® 500 A, friction coefficient 0.12 - 0.18 / Dacromet® 500 A, coefficient de friction 0.12 - 0.18 / Dacromet® 500 A, Reibungskoeffizient 0.12 - 0.18 / Dacromet® 500 A, coefficiente d'attrito 0.12 - 0.18 / Dacromet® 500 A, coeficiente de fricción 0.12 - 0.18	-	600 h	37

1) to red rust / à la rouille rouge / bis Rotrost / alla ruggine rossa / al óxido rojo

2) add code to the part number / ajoutez le code à la référence / fügen Sie den Code zur Artikel-Nummer hinzu / aggiungere il codice al numero di codice / añadir numeración a la referencia